

VOLKSWAGEN TRANSPORTER T6.1 2019-UP KENWOOD HEAD UNIT INSTALLATION GUIDE

Before installing this product, carefully read the fitting instructions to ensure proper installation. Failure to follow these instructions can result in damage to both the vehicle and the accessory. Remember to dispose of any recyclable components or packaging in accordance with local regulations. We strongly recommend having a qualified technician install the accessory. Finally, please store any removed vehicle parts in a safe and secure location.

Always route wiring with existing vehicle harnesses and avoid sharp edges or chaffing point. Keep any harness or microphone leads away from curtain air bags

INTERFACE FEATURES

- Retains Steering Wheel Control Functionality
- Retains Phone Button Functionality
- Retains Vehicle Settings and Generates Settings Menus
- Provides Optional Input for Aftermarket Reversing Camera
- Retains Parking Sensor Audio and Generates Parking Sensor Graphics
- Retain the E-Call functions of the emergency call system
- Provides Outputs for Park Brake, Reverse Gear, Speed Pulse and Mute

TOOLS REQUIRED

- Gloves
- Dash Protection
- Panel Removal Tools
- Multitool / Reciprocating Saw
- Screwdriver
- Wire Strippers
- Crimp Tool
- Installation Tape
- Cable Ties

KIT CONTENTS INTEGRATION KIT



1. Fascia Plate, Metal Brackets, Screws & Washers | 2. Vehicle Interface & Harness | 3. E-Call Retention Interface & Harness | 4. USB Circuit Board for Retention and Voltage Dropper | 5. DAB Antenna Adapter | 6. FM Antenna Adapter | 7. OEM Camera Retention Interface | 8. Head Unit Connection Lead | 9. HDMI Lead

HEAD UNIT

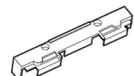
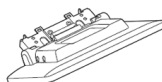
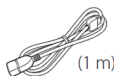
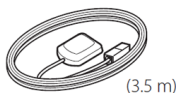
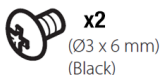
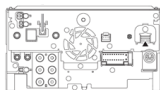

1. Head unit body | 2. ISO Radio Harness | 3. USB extension lead (1M) | 4. Microphone (3M) | 5. Protective Cap
6. Screws x2 (for Protective Cap) | 7. GPS Antenna (3.5M) | 8. Screen | 9. M5 Screws x6 for holding screen to unit

OEM HEAD UNIT REMOVAL



To avoid damage to your dashboard, take extra caution when removing the panels to access the OEM head unit. Make sure to protect the highlighted areas beforehand.



Use a panel removal tool to remove the trim around the clocks. Release the clip at the bottom right corner and the top right corner, giving you enough leverage to release the panel.



Once the clips are released, use your hands to remove the panel from the dashboard. (We recommend using gloves to avoid causing any damage). See step 4 which highlights the clips that secure the trim panel around the clocks.

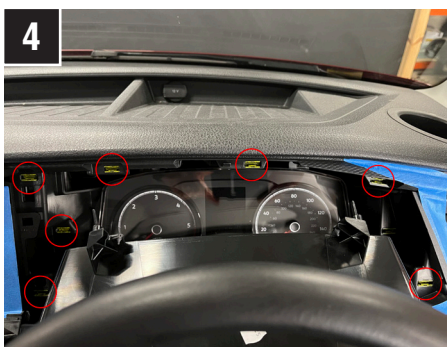

The highlighted clips secure the trim panel around the clocks. Pay attention to these areas to ensure a safe removal without damaging the panel and clips. Once removed, place the trim panel in a safe place, ready to reinstall later.



Using your hands or a panel removal tool, release the trim surrounding the OEM head unit and vents. Firstly remove from the right-hand side; this will enable you to gain enough leverage to release.



6
Remove the trim around the top, bottom and vents to release the panel. See step 7, which highlights the clips that secure the trim panel.

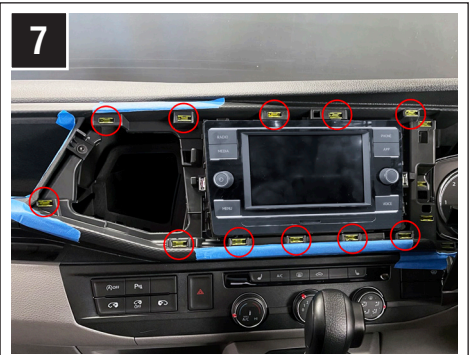

7
The highlighted clips secure the trim panel around the head unit. Pay attention to these areas to ensure a safe removal without damaging the panel and clips. Once removed, place the trim panel in a safe place, ready to reinstall later.



8
Use a panel removal tool to remove the panel which houses the OEM USB ports, this is secured with clips in each corner. (see step 9)



9
The highlighted clips secure the panel. Once released carefully lift from the dash ready to disconnect the OEM connectors. (See step 10)

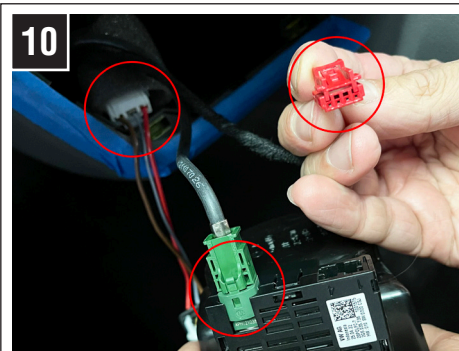

10
The three highlighted connectors need to be released to enable you to remove the panel from the dash. Be careful not to damage the connectors or the panel.

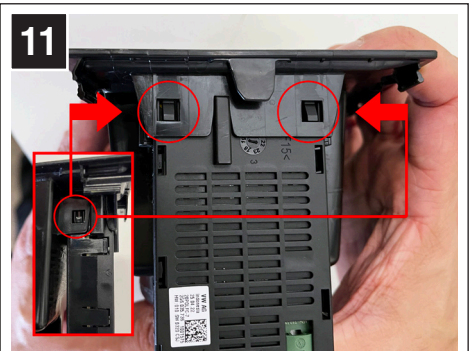

11
Once the panel is released from the dashboard, remove the OEM USB housing. Press the four pins to release from the panel. Two are highlighted on top and two on the side (pictured inset)



Once the USB housing is released, place the pocket panel to the side.

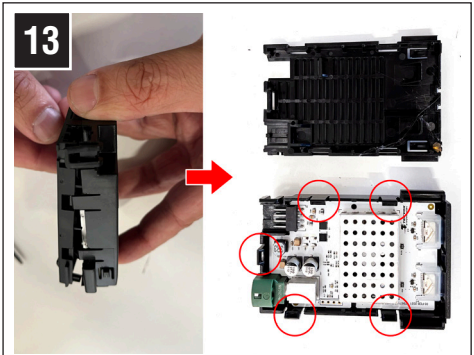

Open the USB housing by releasing the five highlighted clips and opening up to reveal the circuit board.

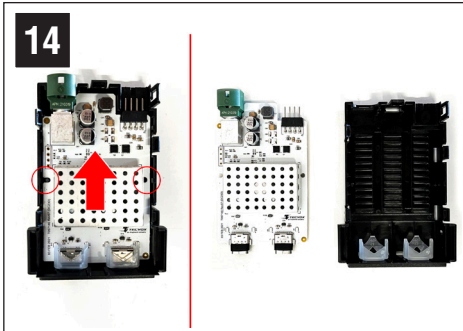

Slide the circuit board away from the ports to separate it from the housing, be careful not to damage the two highlighted pins holding the board in place.

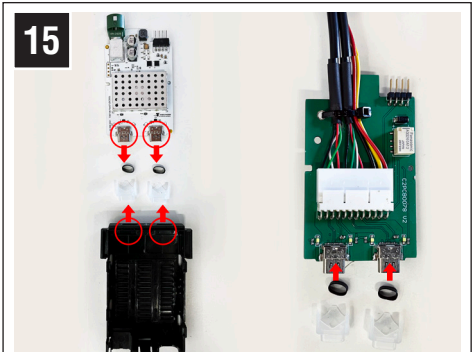

Remove the two black elastic bands and the clear plastic housing from around the USB ports. Now place these on to the aftermarket board supplied with the kit as pictured.

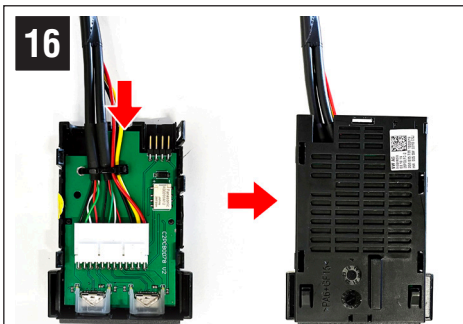

Slide the aftermarket board into the OEM housing panel as pictured so that the two pins secure the board. Reassemble the USB housing with the aftermarket board inside.

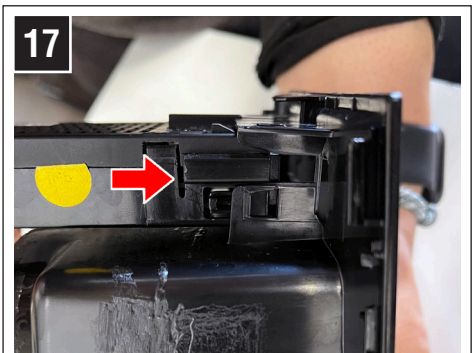

Slide the USB housing back into the panel, ensuring the clips connect to secure together.

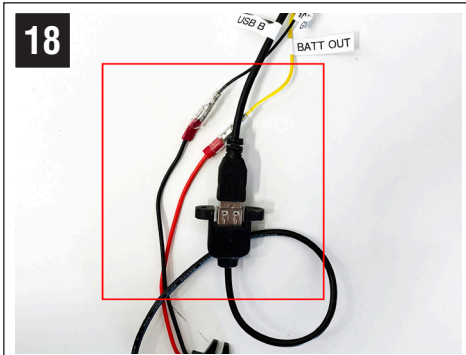

18 Make the three highlighted connections between the aftermarket USB B lead and the voltage dropper. See connections diagram on pages 10 & 11 for reference.

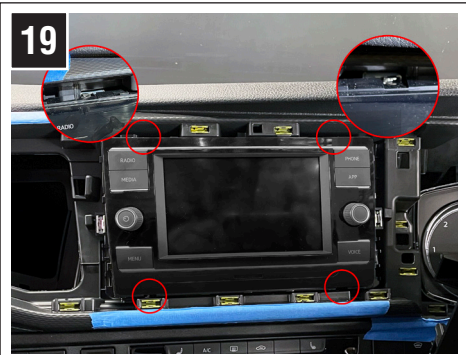

19 Use the supplied head unit release keys to remove the OEM head unit. Push into the highlighted areas to release.



20 First, release the left-hand side of the head unit; once released, use the release keys to remove the opposite side.

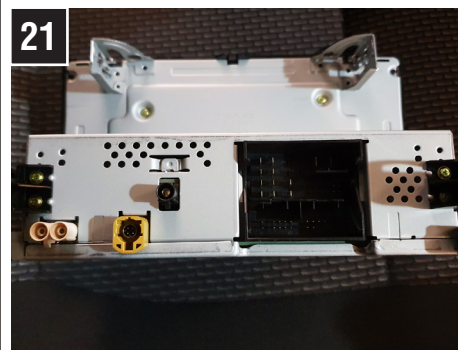

21 Now release the OEM connectors to remove the head unit and place it in a safe place.

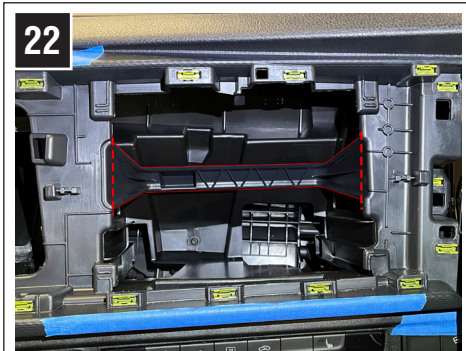

22 Now cut the highlighted plastic panel along the dashed lines to remove.



23 Use a multitool or reciprocating saw to cut the panel. Once removed, discard the panel, as this will not be needed again. **Ensure the area that is being cut is clear of any wires.**

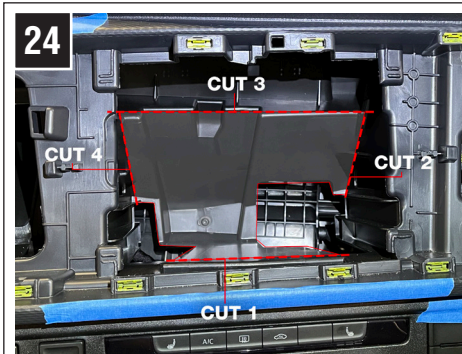

Cut the highlighted panel along the dashed red lines.
 Ensure the area that is being cut is clear of any wires.



Ensure the area that is being cut is clear of any wires.

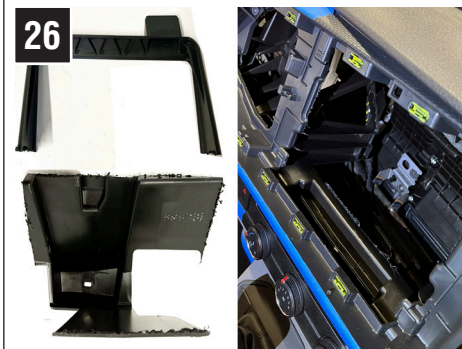

On the left are the cut panels from dashboard. On the right shows the dashboard once cut and ready to install the aftermarket stereo.
 Dispose of any recyclable components in accordance with local regulations.



To remove the glovebox, first remove the side panel with a panel removal tool.



Remove the panel above the glovebox using a panel removal tool to release the clips highlighted in step 29.

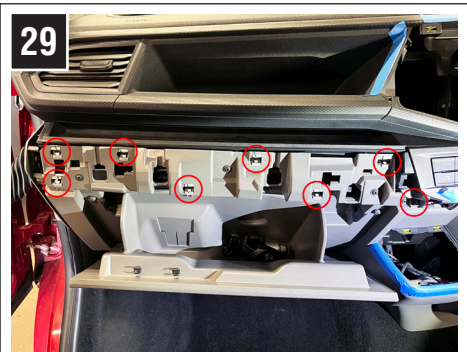

Once removed, place the panel in a safe place, ready to reinstall later.



Remove six screws to release the glovebox. Three are positioned underneath the glovebox, and three are along the top panel underneath the removed trim.

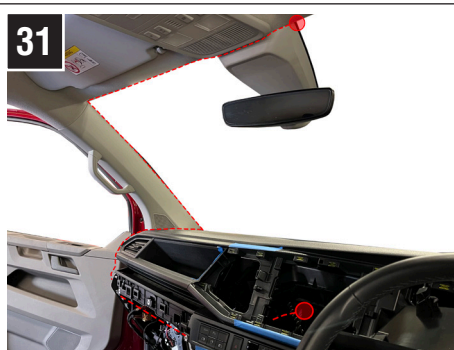

Now install the microphone supplied with the Kenwood head unit.



Fit the microphone clip underneath the roof lining and position it towards the driver. Use a panel removal tool to release the centre panel and tuck the cable in to hide.

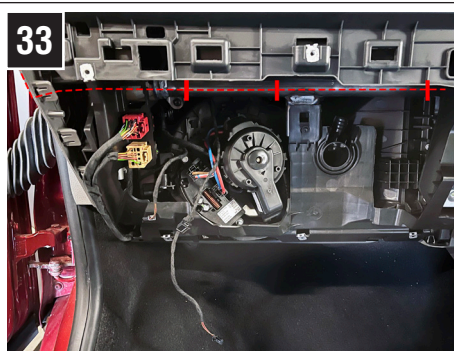

Follow the highlighted path on step 31 to hide the cable along the lining of the vehicle and then run through the side panel and secure it to the metal bar pictured above with cable ties.



Now fit the metal brackets to the fascia plate using the supplied screws and washers as pictured above.

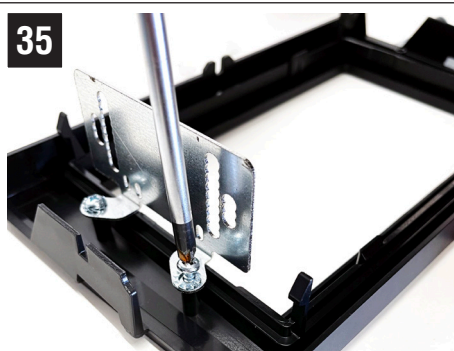

Securely screw the brackets to the fascia as pictured with the metal plate facing inwards. Do this step for both sides.

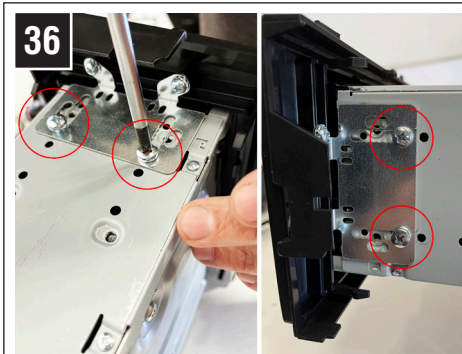

Now use the supplied screws to secure the fascia to the side of the aftermarket head unit as pictured. Do this for both sides.



Once the brackets are secured, you will now have the head unit and fascia together, as pictured above. Use the additional trim supplied to ensure there is no gap around the front trim.

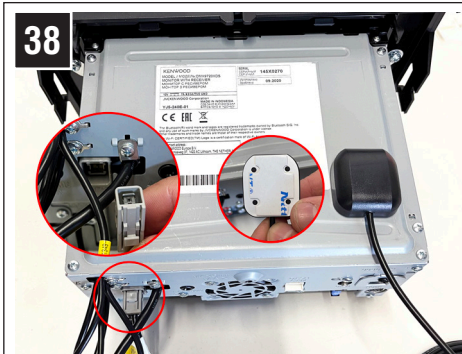

Connect the GPS antenna to the head unit using the grey connector as pictured. Then remove the back of the sticky pad on the GPS antenna and stick it to the top of the aftermarket head unit as pictured.

Please refer to pages 10 and 11 for the harness and adapter connections, following the harness connection diagram provided.

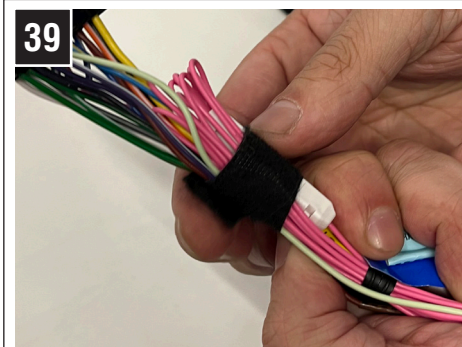

We recommend using black installation tape to tidy all harnesses for a clean installation into the vehicle.

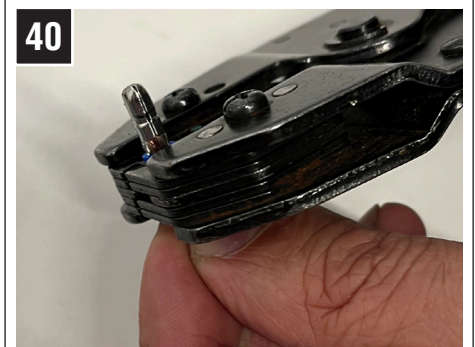

You will need to use a crimp tool and male bullets (not supplied) on bare end wires ready for connection.

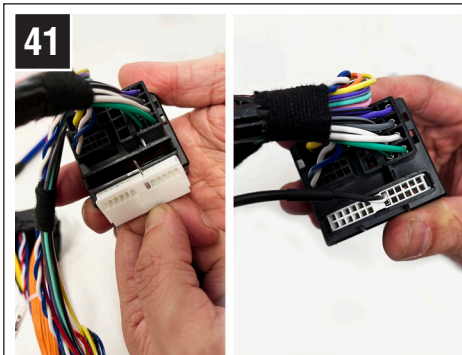

41
Connect the OEM camera retention harness to the vehicle harness connector. This should be connected to the rear of the connector as pictured in the second image. This step only needs to be made if the vehicle has an OEM camera.



42
Connect the vehicle harness, head unit connection lead, and RCA camera lead into the vehicle interface. All dip switches should be in the up 'Off' position.

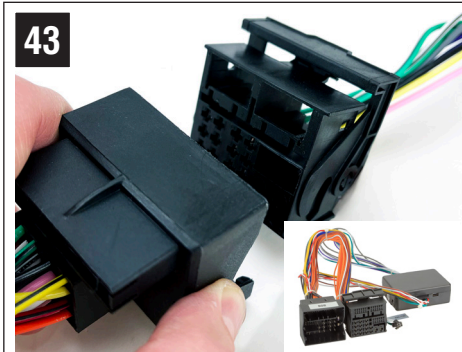

43
Connect the E-Call SOS retention interface (pictured) between the vehicle interface harness and the vehicle harness, as shown in the connection diagram on pages 10 & 11.

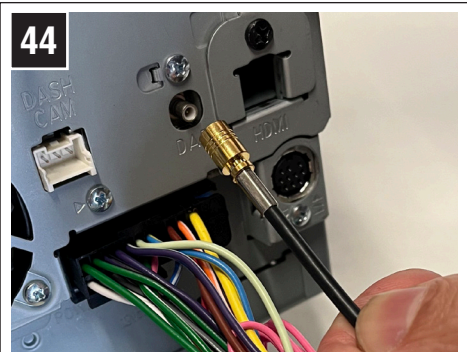

44
connect the DAB antenna to the DAB connection point on the aftermarket stereo.



45
Connect the male RCA reverse camera input from the interface harness to the rear camera input on the back of the aftermarket stereo. Do not connect directly from the radio harness. See connection diagram on page 10-11.



46
Connect the male FM antenna to the female FM antenna on the rear of the aftermarket stereo.

AFTERMARKET STEREO (REAR)

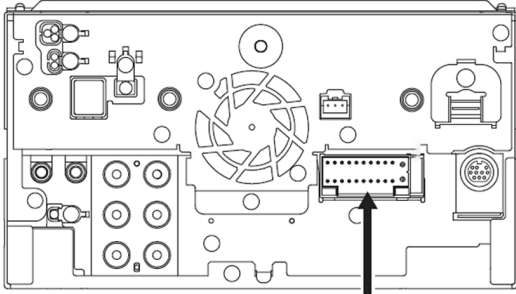

HDMI LEAD. CONNECT TO HDMI PORT ON REAR OF KENWOOD HEAD UNIT.



DAB ANTENNA ADAPTER

CONNECT TO DAB ANTENNA ON AFTERMARKET STEREO AS PICTURED ON STEP 44

CONNECT TO REVERSE CAMERA INPUT AS PICTURED ON STEP 45



CONNECT VEHICLE INTERFACE TO HEAD UNIT HARNESS (ISO) FEMALE TO MALE

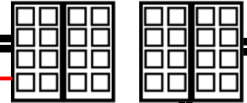

DISCONNECT RED IGNITION CONNECTION ON HEAD UNIT HARNESS

CONNECT TO RED Y-LEAD

USB POWER CONVERTER

USB CONNECTION SECURE WITH INSTALLATION TAPE

VEHICLE INTERFACE HARNESS

HEAD UNIT HARNESS

CONNECT RED TO RED - ACC
BLACK TO BLACK - GND
RED TO YELLOW - BATT

USB SOCKET

BLUE ANT CONT TO BLUE ANTENNA

ANTENNA ADAPTER

CONNECT TO FM ANTENNA AS PICTURED ON STEP 46

PURPLE/WHITE TO PURPLE/WHITE (REVERSE GEAR)

LIGHT GREEN TO LIGHT GREEN (PARK BRAKE)

PINK TO PINK (SPEED PULSE)

BLUE/YELLOW TO PURPLE (HEAD UNIT CONNECTION)

CONNECTION DIAGRAM

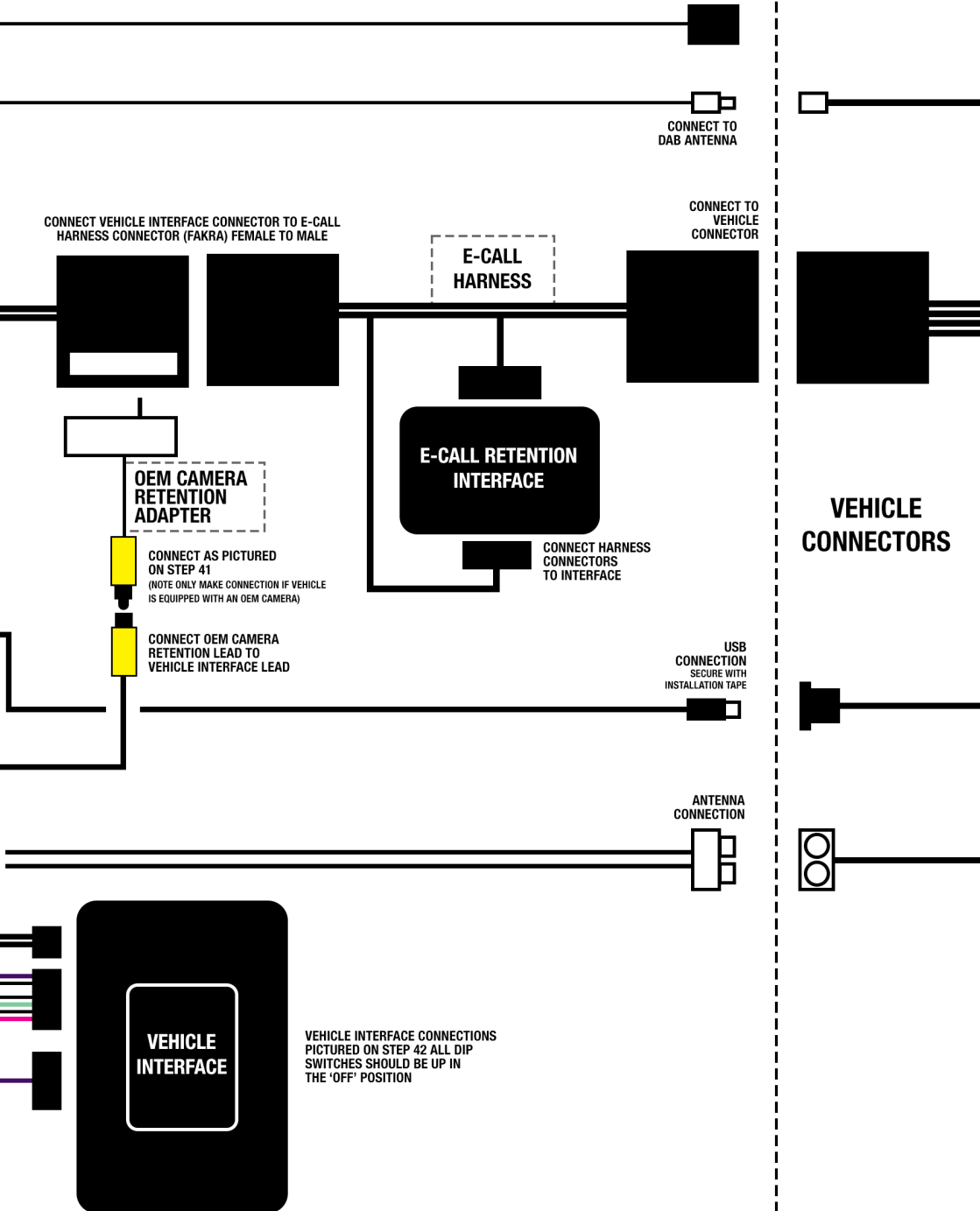

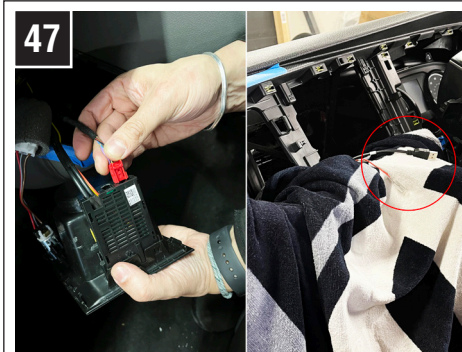

Reinstall the pocket with the USB ports back into the vehicle. Connect the white connector and the red connector. Now run the cables from the USB socket into the dash, ready to connect to the wiring harness.



Connect the Kenwood USB lead to the USB A lead in the dashboard as pictured above. See connection diagram on pages 10 & 11.

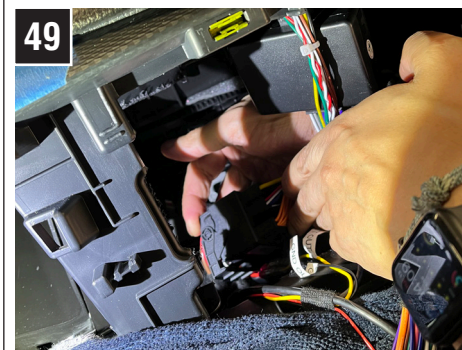

Now connect the vehicle connector in the dash board to the connector from the harness, as pictured in the connection diagram.

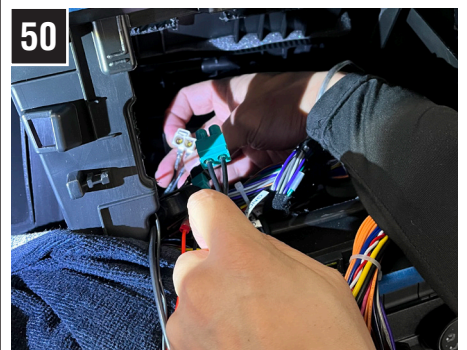

Connect the green antenna adapter to the white antenna adapter in the vehicle dashboard, as pictured in the connection diagram.



Connect the green DAB antenna connector to the DAB antenna connector in the vehicle dashboard, as pictured in the connection diagram.



Now all connections have been made, securely place the harness and interfaces into the vehicle dashboard. You can use foam tape or pads to secure the interfaces to the dash if preferred. Once this is done, carefully place the aftermarket head unit into the dash and ensure you do not trap any wires.



53

Once the head unit and fascia are secure, reinstall all of the panels removed starting with the glove box and side panel then the head unit and vent panel and lastly the panel that surrounds the OEM clocks. All trims should click back into place, reverse the removal steps.



54

Now take the stereo screen and slide it into place as pictured. Use the six supplied screws to secure it in place. See the diagram on page 14 for more information.



55

Now slide the black plastic trim into place. **This step must be done correctly for the head unit to power up.** Screw in to place as pictured using the supplied screws.
See the diagram on page 14 for more information.



56

Now position the screen in place, power up and test. Follow the head unit and interface setup steps to complete installation.

SCREEN CONNECTION & POSITIONING

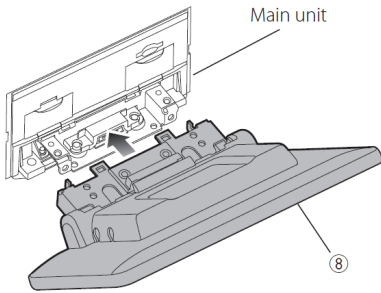

1. Install the display unit to the main unit

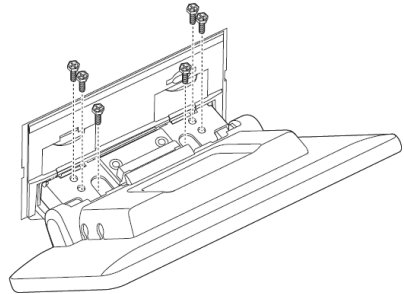

2. Fix the display unit with six hexagon head screws.

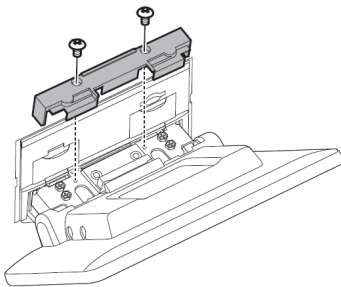

3. Attach the protective cover to coupling part, and then fix it with two binding head screws.

NOTE

If the protective cover is not attached, this unit will not turn on. Even if the unit is turned on, the power may be turned off halfway. Be sure to attach the protective cover.

ADJUSTING THE DISPLAY HEIGHT

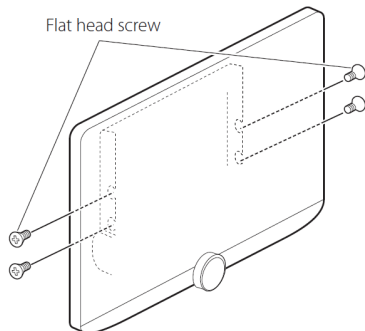

1. Remove the four flat head screws from both sides.

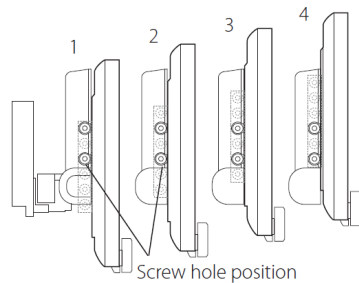

2. Adjust the display height according to the screw hole position. Default is 1.

Reinstall the four flat head screws on both sides and fix the display.

For head unit setup, refer to the supplied instruction manual.

VEHICLE INTERFACE USER GUIDE

The vehicle interface will retain several of the vehicle's original steering wheel control functions including moving up and down between tracks, adjusting the volume and picking up or hanging up calls.

In addition to this functionality, the vehicle's steering wheel controls are also used to enter, exit and navigate the menus.

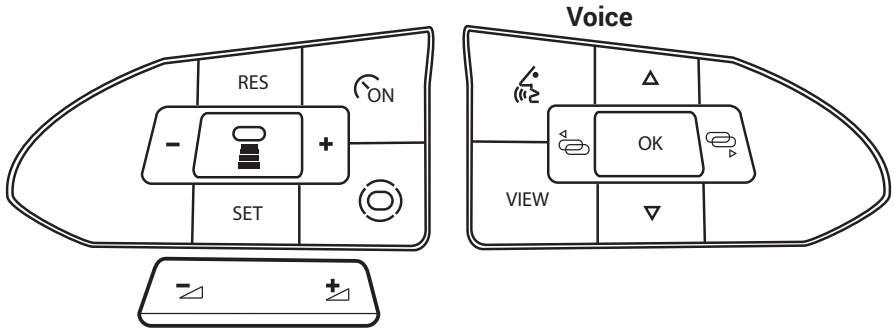

Phone Control



VOICE Button

Press VOICE once to pick up.
Press VOICE twice to hang up.
Hold VOICE to activate voice control.

Navigating the Infodapter Menus

Five (5) presses of VOICE button to enter the configuration menu.

Short press VOICE to enter a sub-menu or confirm an option within a menu.

Long press VOICE to return to the previous menu.

Press TRACK + to scroll up through the menu items, or to increment an option within a menu.

Press TRACK - to scroll down through the menu item, or to decrement an option within a menu.

Exiting the Configuration (Main) Menu

Press and hold the VOICE button whilst in the top level Configuration Menu to exit the Infodapter menu system and return to standard stereo operation.



Driving Mode

The driving mode button can be used as normal. The graphic for the mode will be shown on the head unit display.



Park Assist

The park assist button can be used as normal to activate or deactivate park assist. The graphic will be shown on the head unit display.

Reverse Priority Display

Select between reverse camera image or parking radar with one press of the VOICE button while reversing.

Note: this option is only available when 'Camera Connected' is set to YES in the preferences menu.



Press VOICE Once

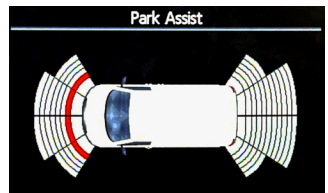

CONFIGURATION MENU

VEHICLE SETTINGS

The Infodapter interface retains the ability to adjust vehicle settings that were present when the original head unit was installed.

The options available will depend on the individual vehicle and system specification. These might include lights, locks, mirrors, time & date and much more.

See the vehicle handbook for more information regarding these features and how they operate.

INFODAPTER SETTINGS

Screen Size/Position

Change horizontal and vertical screen size/position to align the Infodapter with the aftermarket display.

Picture Settings

Adjust the brightness, contrast and colour saturation.

Preferences

Change options based on vehicle functionality and specification.

VAN (Trip Computer)

Access the vehicle's trip computer and view data including distance travelled, fuel consumption etc. Use the track up to toggle data, use track down to exit the VAN screen and return to the configuration menu.



Exit VAN menu



Navigate VAN menu

In the Trip Computer, a short press of VOICE will reset that screen, e.g., A short press of the voice button on the "Since start" screen will reset the since start data. Track Up will move between the various displays: Since start, Long term, Since refuelling. Track down will exit out of the menu.

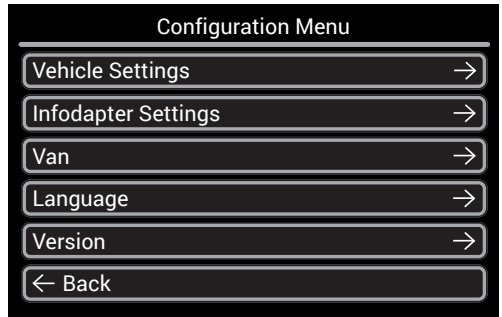

VAN (Trip Computer)

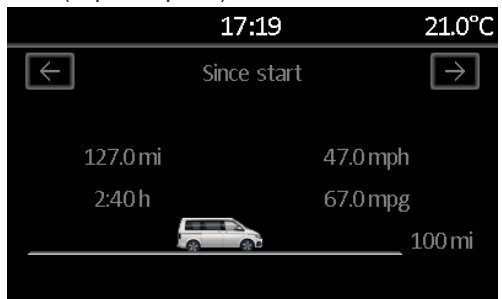

LANGUAGE

Select language (English/French/German/etc).

VERSION

View software version screen.

PREFERENCES (SUB-MENU)

Driver Position

Select Left or Right depending upon whether the vehicle is left or right-hand drive.

Camera Connected

Select Yes if an optional camera is connected.

Reverse Priority

Select whether camera or park assist image is shown by default when reversing.

Park Brake Source

Set Park Brake output to activate when park brake is on (Park), when speed is less than 3km/h (Speed) or to remain on at all times (Always On).

Climate

Select how long the climate display will be shown on the head unit when adjusted. Selectable range is between 0 (disabled) and 30 seconds.

Restore Factory Settings

Restores all Infodapter settings to factory defaults. Note: this does not restore vehicle settings to defaults.

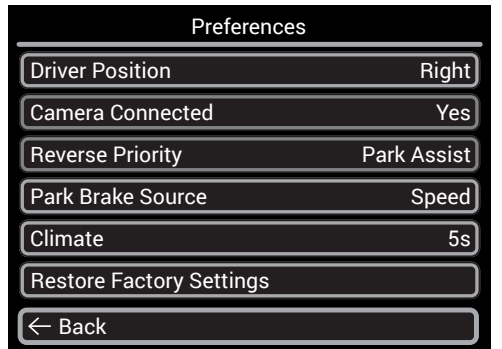

Climate Control Type

Select Manual or Automatic
Set this to the appropriate HVAC type in the vehicle. If the vehicle has manual climate controls, then the Climate timeout will be hidden.

Parking Radar Image

Select Van or Car
Set this to display the appropriate vehicle image on the parking radar.